

1. Open up the document or web page that you want to print, and select "Print" from the file menu.
(In this example, we're printing PowerPoint slides)

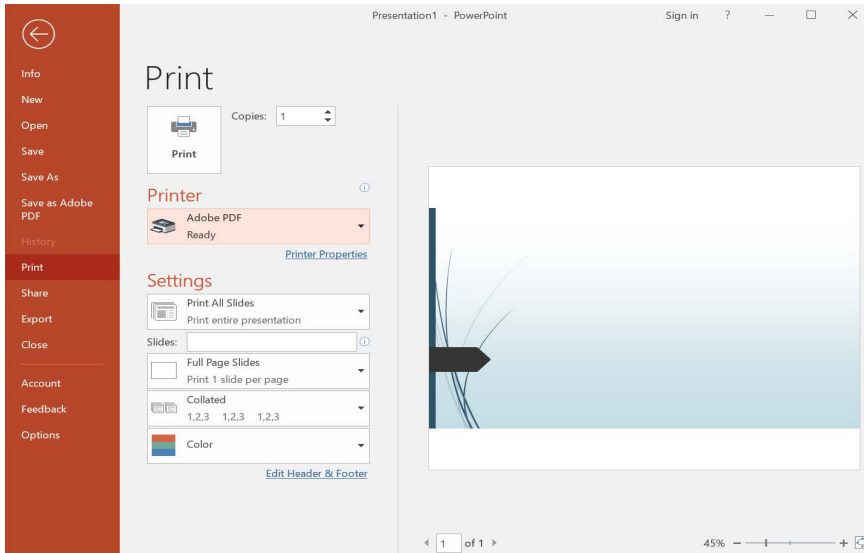

2. The print dialog box opens. Select the printer to which you'll send your print job

In this example, we're going to send the job to the black & white printer located in the lobby of Multi-Media Services in DRL. The name of this printer is DRL_MMS_LOBBY_BW

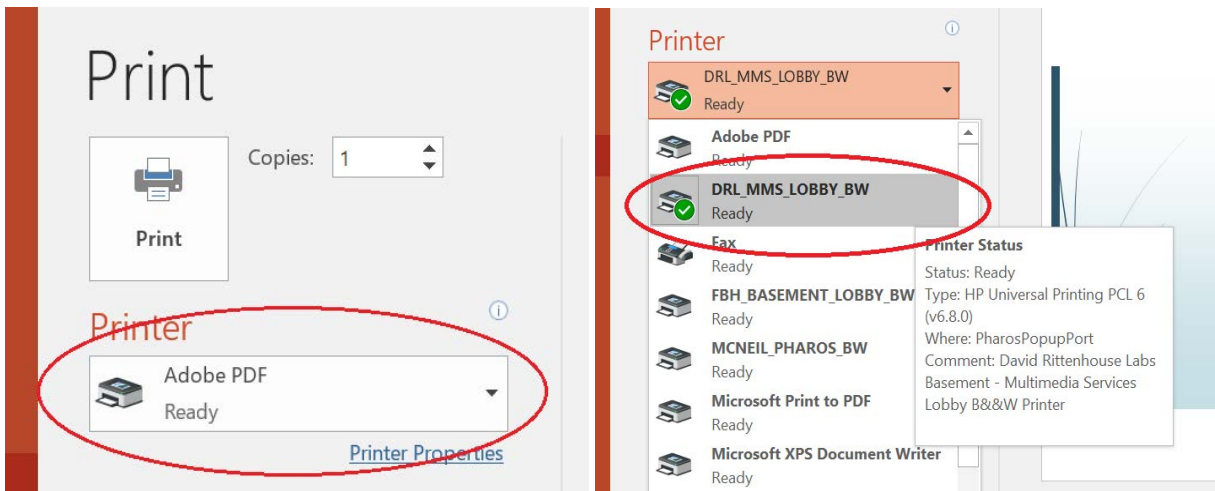

- To select single-sided or double-sided printing. Click on the drop down menu below and make your selection for single-sided or double-sided printing.

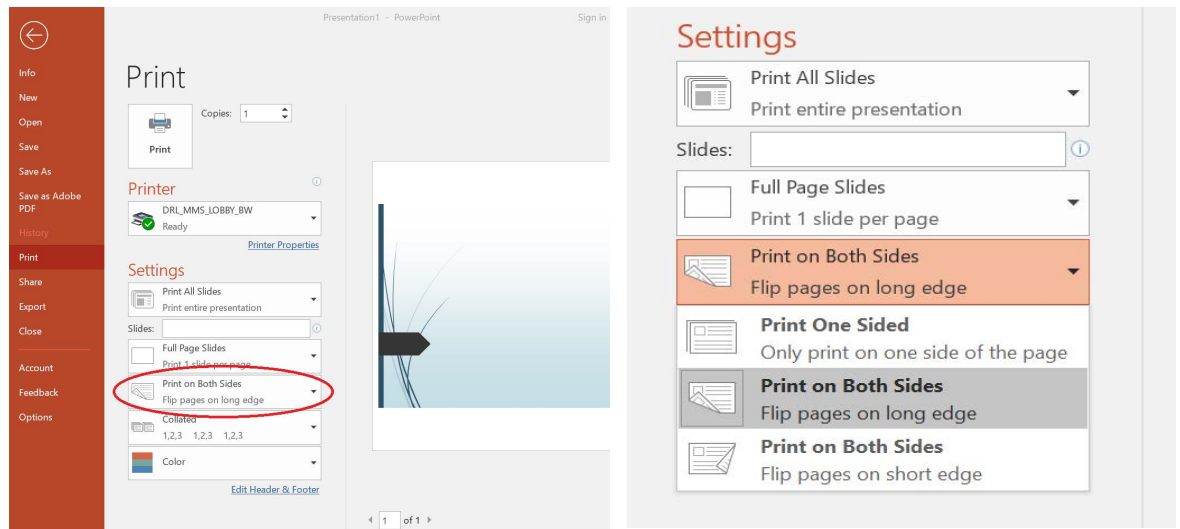

- Now you're ready to click Print.

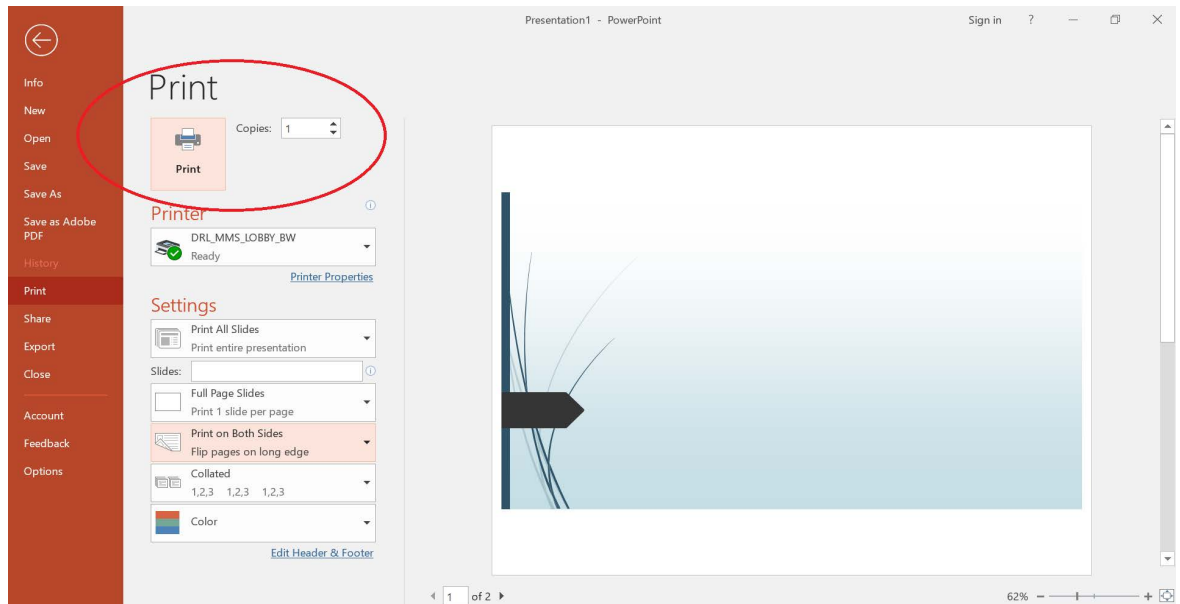

5. Set a name and password for your print job; specify how many copies to print

Enter your PennKey user name in the top box. This will help you find your job when you go to the print release station; jobs will be listed alphabetically by the PennKey of people who have submitted jobs to that printer.

Then, enter a simple password that you'll use to release your job; enter it again to confirm that you've typed the password correctly. Putting a password on your job means that no one else will be able to print out your work.

Finally, enter a name that will help you identify this specific job.

Print Job Details

Please enter your PennKey username

Please enter a name for your print job

Please enter a temporary password that you will use to retrieve your print job at the release station

Please DO NOT use your PennKey Password!

Pharos Systems illuminate

Next Cancel

Click "NEXT" You'll be asked how many copies you want to print

Print Job Details

How many copies of this job would you like?
 Enter the number of copies you require here

Pharos Systems illuminate

Previous Print Cancel

Click "PRINT" to send your job to the printer.

6. Go to the release station and collect your printout.

Swipe your card at the release station; you'll see a screen which displays all jobs waiting to print. Find your job, click on the title and click the PRINT button. You'll be prompted to provide the password you set for the job. Your PennCash account will be charged, and your job will print.

Pharos
Station

Releasing Print Jobs

This screen allows you to release print jobs to a printer. Select a job and click print or delete.

Refresh

Jobs Sorted by Date and Time

Job Name	Owner	Date
cell phone bills	efallon	10/13/2008 5:05...
tech docs	sabella	10/13/2008 5:04...
psych paper	albertm	10/13/2008 5:04...
mktg 423 ppt	macderm	10/13/2008 5:03...

Logoff

Balance
Total **\$18.77**

Print Delete

5:05:58 PM